

Optional:



High speed

MODEL MKS

TECHNICAL SPECIFICATIONS

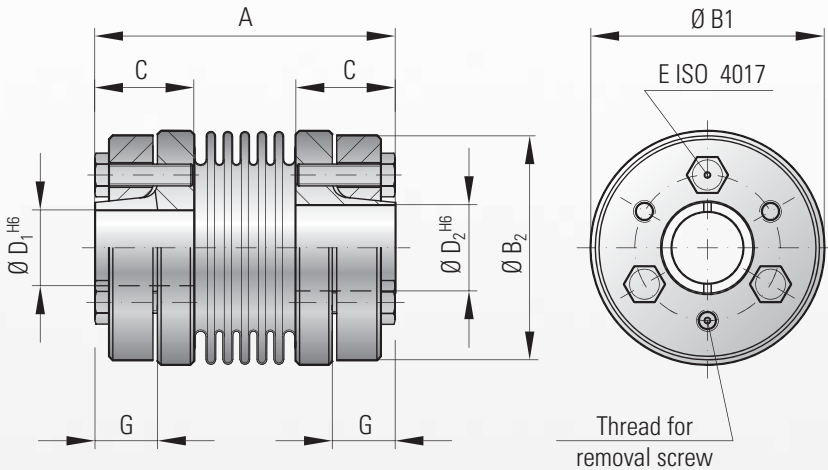

with conical clamping rings

Features:

- for high speed applications
- compensates for 3 types of misalignment
- high strength conical clamping connection
- for highly dynamic applications

Material:

Bellows made from highly flexible, high grade stainless steel; hubs and conical clamping rings made from high strength aluminum

Design:

Hubs with conical clamping rings, each with 3/4x ISO 4017 fastening screws

Temperature range:

-30 to +110° C (-22 to +230° F)

Balancing grade:

Standard balancing grade G = 2.5

Speeds:

Maximum 120,000 rpm*

Service life:

Maintenance free with infinite life when operated within the technical specifications

Fit tolerance:

Overall clearance between hub and shaft 0.01-0.025 mm

Non standard applications:

Custom designs with various tolerances, materials, dimensions, etc. available upon request

Ordering example

MKS/45 / 10 / 8 / XX

- Model
- Series
- Bore Ø D1 H6
- Bore Ø D2 H6
- Non standard e.g. anodized

Model MKS			Series	
			45	100
Rated torque	(Nm)	T _{KN}	4.5	10
Overall length	(mm)	A	42	48
Outside diameter	(mm)	B ₁	32	40
Hub diameter	(mm)	B ₂	30	38
Fit length	(mm)	C	14	16
Inside diameter possible from Ø to Ø H6	(mm)	D _{1/2}	6-10	8-14
Fastening screw ISO 4017	(mm)		3x M3	4x M3
Tightening torque of the fastening screws	(Nm)	E	1.3	1.3
Distance	(mm)	G	8.5	9.5
Moment of inertia	(gcm ²)	J _{total}	65	160
Approximate weight	(g)		51	75
Torsional stiffness	(Nm/rad)	C _T	7000	9050
Axial	± (mm)	max. values	0.5	0.75
Lateral	± (mm)		0.1	0.05*
Angular	± (degree)		0.5	0.5

1 Nm = 8.85 in lbs

Note: It is very important to precisely align the shafts when operating at high speeds.

For speeds over 50,000 please refer to specifications marked with an asterisk*